

Planarcell: Description and Specification

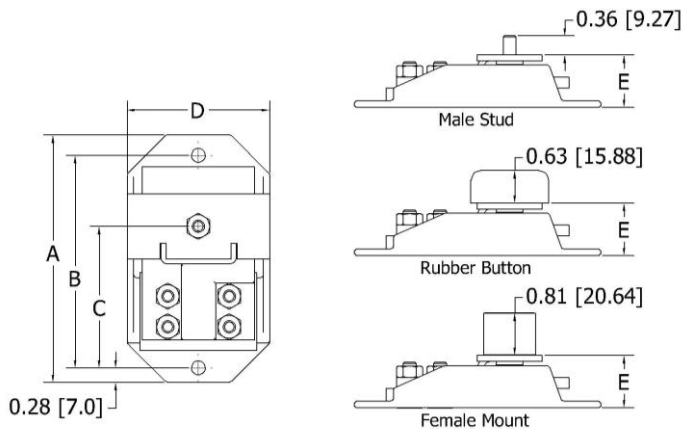

DESCRIPTION

The Planarcell allows direct mounting of a platter etc. in low profile platform scales. Four Planarcells are located at the corners of a weigh platform that can be any size and shape. Different capacities allow a single set of components to be used in a family of scale platforms of many sizes and capacities. The Planarcell has overload protection built-in and can be used with confidence in applications where dropped items and other abuse is present.



FEATURES

- Capacity range 7.5 to 150 kg
- Fully overload protected
- High stiffness gives fast response
- Less than 2" high, allowing low profile platform construction
- IP65 protection
- 1000 ohm impedance reduces electrical load and self-heating
- Allows wide range of platform sizes
- Different platter mounts available to allow secured or drop-on platters
- Accurately matched output allows total interchangeability and replacement without calibration

APPLICATIONS

- High accuracy platform scales
- Conveyor scales
- Packaging systems
- Checkweighers
- Tank and vessel weighing
- Shipping systems

Type	A	B	C	D	E
7.5kg	TBA				
37.5kg	TBA				
50kg	4.75"	4.08"	2.71"	2.75"	1.01"
75kg	4.75"	4.08"	2.71"	2.75"	TBA
150kg	TBA				
Button	1.5" dia				0.63"
Female	1/4"-20 UNC				0.81"
Male	1/4"-20 UNC Stud				0.37"

SPECIFICATIONS

Planarcell size:	4-3/4" x 2-3/4" x 1.82" overall height with load button shown
Rated capacity:	7.5, 37.5, 50, 75 or 150kg. Contact us for other capacities
OIML accuracy class:	C3, 3000 divisions. C4, 4000 divisions available
Corner balance:	Current and voltage matched to within $\pm 0.1\%$.
Output:	1.00 mV/V at full capacity.
Excitation, Zero balance	5 – 15 volts, zero balance ± 0.1 mV/V
Creep error, 30 min	$\pm 0.024\%$ of load
Zero return error, 30 min	$\pm 0.0167\%$ of applied load
Temperature span error	$\pm 0.001\%$ of applied load / °C
Temperature zero error	$\pm 0.00186\%$ of rated output / °C
Output impedance	1000 \pm 10 ohm
Input impedance	1160 \pm 10 ohm
Temperature range	Operating -10 to +40 °C. Storage -30 to +70 °C
Safe vertical overload	300 kg static or dynamic shock load
Safe side overload	200 % of rated capacity
Sensing element:	Vishay 380 planar beam, or equal
Transmitter R1930:	Serial RS232 output, mounts separately
Environmental protection	IP65. Dust cover optional
Cable and connections	1.5m flat 26 AWG, +exc=grn, -exc=blk, +sig=red, -sig=wht

Note: Although the Planarcell's accuracy meets all legal requirements for 3000 divisions, this scale has not been NTEP or Canadian Weights and Measures approved. If required, contact us regarding this subject.

RECOMMENDED MOUNTING METHODS

The Planarcell mounting point requires a resilient coupling to the platter in order to achieve rated accuracy. This means that the structure placed on top of the Planarcell must be isolated by rubber platter mounts to allow this necessary freedom; if the cells are jammed laterally, a scale error may be experienced. Our recommendation is that the platter be mounted so that the rubber mounts fit into the extreme corners of the platter and allow at least 2mm play in every direction to ensure that manufacturing and assembly tolerances will never result in jamming. Alternatively, if screw mounts are required, the screws should allow enough play before tightening to avoid side loading during assembly.

For mounting recommendations and precautions, please see "Planarcell mounting information".

For appropriate transmitters and weight indicators, please contact us at the locations given below.

RL Scales can provide full design engineering for your application, including specialized electronics and software. Contact us for further details.

RL Scales div. Scale-Tron Inc.

www.rlscales.com

Email: info@rlscales.com

6428 Trans-Canada Highway, St. Laurent, QC, H4T 1X4, Canada.

Tel: +1 514 940 0337, Fax: +1 514 940 0342